

NWIFCA vessel procurement

Background

- Delay in procurement process to formulate legal agreements needed and for LCC to understand complexities of procuring a vessel
- Instruction from Finance sub-committee on 21 March to review vessels available

Current vessel

- Solway Protector
- 16m GRP
- 24 years old



Current NWIFCA vessels

- Solway protector
- Barrow RIB 6m
- Liverpool RIB 7m
- Whitehaven RIB 8m
- Morecambe Bay zodiac 5m



Ribs coded to 30 miles from port.
Can cover most vessel enforcement requirements throughout District

Why catamarans?

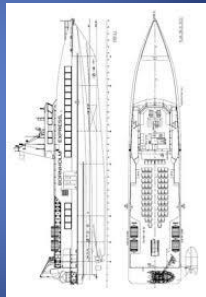
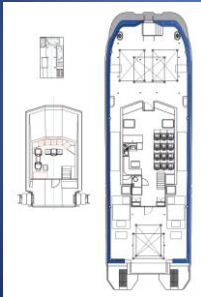

Specification of proposed new vessel

- 24m length
- Aluminium
- Catamaran (twin hulled)
- Budget £3.5M

Musling marine 24m
Supacat £3.5M

South Boats 24m wind farm
crew transfer vessel £3.2M



Various aluminium
wind farm crew
transport vessels
similar to this
Solway Challenger:
19m
£1.95M



Vessel requirements:

- **Enforcement:** speed, rapid reaction, surprise, boarding capability
- **Survey:** stable platform, clear work area, deployment of gear, dry out on sand/mud flats, lab, office

NWIFCA enforcement requirement

22m 47 tons, fixed pitch prop.
Cost new £2.4M



- 6 miles
- New byelaw 2: inside 3 miles < 10m length
inside 6 miles < 15m length
- Mostly under 10m vessels, potting, recreation angling vessels
- Large Nephrops vessels (25m class) will be prohibited from entering the District with any gear in the water.

Cabin rib Patrol vessel



Enforcement vessel trends in other IFCA and EA

	New vessel	Tasks	cost
Kent & Essex	15m cat	Enforce & Sci	£600K
Eastern	11m cabin rib x2	Enforce	£200K x2
Northumberland	16m cat	Enforce & Sci	£700K
Devon & Severn	12m cabin rib x2	Enforce (for Sci use EA)	£800K x2
Environment Agency	18m cat x4 and smaller vessels	Science	£1.5M each
NWIFCA	24m cat	Enforce & Sci	£3-3.5M

Cabin rib type



18m Alicat Wind farm crew transfer and service vessel.
Aluminium, jet drives, Seats 12 . £1.4M

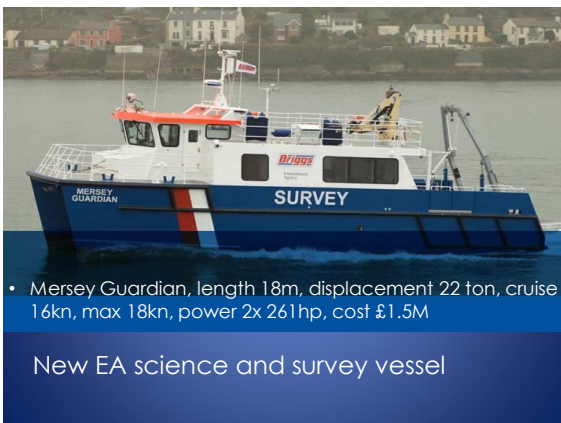

- Mersey Guardian, length 18m, displacement 22 ton, cruise 16kn, max 18kn, power 2x 261hp, cost £1.5M

New EA science and survey vessel

Vessel purchase & running costs

Builder/owner	Length	Weight	Power	Fuel l/hr @24 kn	Cost
Mustang cabin rib IFCA cabin ribs	10-13m	5-10 tons	30kn	150-200	£200-£600K
IFCA Enforce & Sci Cats x 2	15-17m	25-30 tons	25-30 kn	200-300	£600-700K
Alicat / South boats cat crew transport .	16-20m	35-40 tons	1600-2000kw	400	£1-2M
EA Coastal survey	18m				£1.5M
Alicat/ South boats	22-24m	50-70 tons	2000+k w	500+	£2-4M
Mustang Supacat	24m	80 - 130 tons with payload	2x 1400 30-35Kn		£3.5M

For sale in Great Yarmouth: 20m WFSV, Draught 1.1m, Displacement 41 tons, 28 kn max, 24kn cruise 360l/hr fuel. Fixed pitch prop. Cost £1.75M



Ctruk 20T MPC, length 20m, Displacement 24 tons, Speed max 30kn, cruise 25kn, 100-200l/hr fuel power 2x 610 hp water jet. Price new £1.3M



Cwind astute Speed max 30kn, cruise 25kn, Length 20m 2 years old. In Barrow for sale £800,000 but may not take weight of a boarding RIB



Summary

Length	Purchase price	Running costs
16m	£700K	1
20m	£1.5- 2M	1.5
24m	£3-4M	2.0

Running costs include fuel, maintenance, berthing Annual refit.

All sizes require a minimum crew of 3

Fabric	Build cost	Running cost
Aluminium	3.0	2.0
GRP/Composite	2.0	1.0

Aluminium v composite

- Aluminium is heavier
- More expensive to build
- More expensive to run
- More difficult to repair
- Takes longer to build

Options – in order of cost

1. Do nothing. Maintain Protector and use ribs – Cheapest option
2. Purchase 1 x cabin ribs for enforcement. Hire EA vessel for science @ £1500/day. Cost £0.7M. Within budget using reserves.
3. Purchase 1 x 18m science and enforcement vessel to cover all essential offshore work. Cost £1.2M
4. Purchase 1 x 12-13m cabin rib and 1x 18m science vessel. Cost £1.7M.
5. Continue with procurement of a single 24m patrol vessel for science and enforcement. Cost £2.5-3.5M.

Recommendations

- Reconsider vessel provision to meet today's needs
- Amend specification accordingly
- Include composite building material as alternative to aluminium